

WorkForce WF-7610DWF



DATASHEET



Ideal if you need to print A3-sized documents on a regular basis, this business printer with Wi-Fi and Ethernet features fast business-quality printing of up to 18ppm¹ and 10.9cm touch-screen. It also comes with a front-loading paper tray and features high yield cartridges to help printing costs low. Print up to 2,200 pages² with the XXL black ink cartridge.

A3 duplex 4-in-1

This business printer comes with a 35-sheet automatic document feeder and offers A3 duplex print, scan, copy and fax. As well as the front loading paper tray, the rear speciality paper path means you can print on a wide range of thicker paper, envelopes or labels to suit your business needs.

Mobile printing

Epson Connect³ allows you to print important office documents from smartphones and tablets. You can also print from anywhere in the world by emailing files directly to the printer, and store scanned documents in cloud services. In addition, this printer is also Google Cloud Print and Apple AirPrint compatible. For added versatility, Wi-Fi Direct™ allows easy printing from wireless devices without having to connect to a wireless router.

New printhead

PrecisionCore, Epson's most advanced printhead technology, powers the industry-leading output quality and durability that Epson is renowned for, at the high speeds required for office, commercial and industrial printing.

Durable ink

Epson's DURABrite Ultra Ink is ideal for producing laser-like business documents. Documents are water, smudge and highlighter resistant, while its quick-drying properties make it perfect for duplex printing. Available in 27XXL, 27XL and standard sizes, these high-capacity, individual ink cartridges offer great savings, with a 50% lower cost-per-page than competitive lasers⁴.

KEY FEATURES

- **A3 4-in-1**
Duplex print, scan, copy and fax
- **Fast print speeds**
Business-quality 18ppm printing¹
- **Connectivity**
Wi-Fi, Wi-Fi Direct and Ethernet
- **Front paper tray**
250-sheet capacity
- **Epson Connect**
Freedom to print and scan anywhere

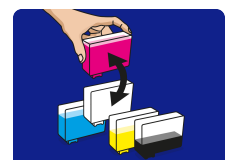

PRODUCT SPECIFICATIONS

TECHNOLOGY	
Printing Method	PrecisionCore™ Print Head
Minimum Droplet Size	2,8 pl, With Variable-Sized Droplet Technology
Ink Technology	DURABrite™ Ultra
Nozzle Configuration	800 Nozzles black, 256 Nozzles per colour
Category	Office
All-in-One Functions	Print, Scan, Copy, Fax

PRINT	
Printing Speed ISO/IEC 24734	18 Pages/min Monochrome, 10 Pages/min Color
Maximum Printing Speed	32 Pages/min Monochrome (plain paper), 20 Pages/min Color (plain paper)
Duplex Printing Speed	8,7 A4 Pages/min Monochrome, 6 A4 Pages/min Color
ISO/IEC 24734	
Printing Resolution	4.800 x 2.400 dpi
Max Duty cycle	20.000 Pages per month
Colours	Black, Cyan, Yellow, Magenta

For detailed information on printing speeds please visit <http://www.epson.eu/testing>.

SCAN	
Scanning Resolution	1.200 dpi x 2.400 dpi (Horizontal x Vertical)
Output formats	BMP, JPEG, TIFF, PDF, searchable PDF
Scanner type	Contact image sensor (CIS)

FAX	
Fax speed dials (max)	200 names and numbers
Page memory	Up to 550 pages/ 6MB (ITU-T No. 1 chart)
Fax Functions	Favorites, PC Fax, Auto Redial, Speed Dial
Type of fax	Walk-up black and white and colour fax capability
Fax Transmission Speed	Up to 33.6kbps / Approx. 3 sec/page
Error correction mode	CCITU/ITU Group3 fax with Error Correction Mode

PAPER / MEDIA HANDLING	
Paper Formats	A3+, A3, A4, A5, A6, B4, B5, C4 (Envelope), C6 (Envelope), DL (Envelope), No. 10 (Envelope), Letter, 9 x 13 cm, 10 x 15 cm, 13 x 18 cm, 16:9, User defined, Legal
Automatic Document Feeder	35 Pages
Duplex	Yes
Paper Tray Capacity	250 Sheets Standard, 250 Sheets maximum
Number of paper trays	1
Compatible Paper Weight	64 g/m ² - 256 g/m ²
Output Tray Capacity	125 Sheets

CONNECTIVITY	
Interfaces	Wireless LAN IEEE 802.11b/g/n, Ethernet interface (100 Base-TX / 10 Base-T), Hi-Speed USB - compatible with USB 2.0 specification, Wi-Fi Direct
WLAN Security	WEP 64 Bit, WEP 128 Bit, WPA PSK (TKIP), WPA PSK (AES)

LOGISTICS INFORMATION

SKU	C11CC98302
EAN code	8715946529592
Dimensions Single Carton	1100 x 3165 x 1030 mm
Carton Weight	153 Kg
Multiple Order Quantity	1 Units
Country of Origin	Indonesia
Pallet Size Euro	8 Units



Epson Italia SpA, μ
 : 210-8099499
 fax: 210-6828615
 info@epson.gr
 www.epson.gr

Seiko Epson Corporation

WorkForce WF-7610DWF

WHAT'S IN THE BOX

- Power cable
- CD Manual
- Warranty document
- Main unit
- Software (CD)
- Individual Ink Cartridges
- Quick Start Guide
- Driver and utilities (CD)

INK CARTRIDGE COMPATIBILITY



INK YIELD DATA

	Alarm clock 27XL	Alarm clock 27XXL	Alarm clock 27
●	1.100 pages*	2.200 pages*	350 pages*
● ● ●	1.100 pages*		300 pages*

* Approx. page yield based on ISO/IEC 24711/24712 or ISO/IEC 29102/29103. Actual yield will vary depending on images printed and usage conditions. For more information visit <http://www.epson.eu/pageyield>

1 - Determined in accordance with ISO/IEC 24734 showing the average of ESAT from the Office Category Test for default A4 simplex and duplex. For more information, please visit www.epson.eu/testing 2 - Approx. page yield based on ISO/IEC 24711/24712. Actual yield will vary depending on images printed and usage conditions. For more information visit www.epson.eu/pageyield 3 - Epson iPrint requires a wireless connection and the Epson printing app. Epson Email print, Epson Remote Print Driver and Epson Scan-to-Cloud require a connection to the internet. For more information, supported languages and devices, please visit www.epsonconnect.eu 4 - For more information, please visit www.epson.eu/inkjetsaving

EPSON®